

# Bourdon Tube Pressure Gauge Type 111.12DW, Black Plastic Case Drinking Water Series - Center Back Mount

WIKA Datasheet 111.12DW

## Applications

- Safe for applications where water is anticipated to be used for human consumption.
- For applications in which products must comply with the 2014 US Safe Drinking Water Act and NSF 61/372.

## Product features

- Brass wetted parts with lead content  $\leq 0.25\%$ .
- NSF/ANSI 61 listed and certified to NSF/ANSI 372 and conforms with the lead content requirements for lead-free plumbing as defined by California, Vermont, Maryland, and Louisiana state laws and the U.S. Safe Drinking Water Act.



Bourdon Tube Pressure Gauge Type 111.12DW

## Specifications

### Design

EN 837-1 & ASME B40.100

### Sizes

1½", 2" and 2½" (40, 50 and 63 mm)

### Accuracy class

$\pm 3/2/3\%$  of span (ASME B40.100 Grade B)

### Ranges (All ranges not stocked)

Vacuum/Compound to 30" Hg (-1 bar) / 0 / 200 psi (16 bar)

Pressure from 15 psi (1 bar) to 600 psi (40 bar) or other equivalent units of pressure or vacuum (Drinking water applications typically do not exceed 300 psi/20 bar)

### Working pressure

Steady: 3/4 of full scale value

Fluctuating: 2/3 of full scale value

Short time: full scale value

### Operating temperature

Ambient: -40°F to 140°F (-40°C to 60°C)

Media: 140°F (+60°C) maximum

### Temperature error

Additional error when temperature changes from reference temperature of 68°F (20°C)  $\pm 0.4\%$  of span for every 18°F (10°K) rising or falling.

### Pressure connection

Material: Lead-free copper alloy (lead content  $\leq 0.25\%$ )

Center back mount (CBM)

1/8" NPT (size 1½")

1/4" NPT (size 2" & 2½")

### Bourdon Tube

Material: Lead-free copper alloy

C-shape

### Solder

No-lead solder

### Movement

Copper alloy

### Dial

White plastic with stop pin (1½", 2", 2½")

### Pointer

Black ABS plastic

### Case

Black plastic

### Window

Clear plastic, snap-fit

## Optional Extras

- Slip-fit or friction ring
- Glass window
- Black painted steel case
- Custom dial layout
- Other pressure scales available:  
bar, kPa, MPa, kg/cm<sup>2</sup> and dual scales

## Dimensions

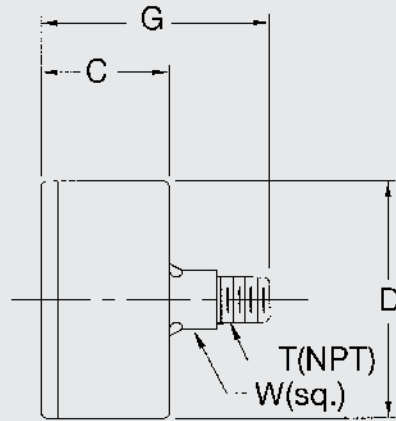
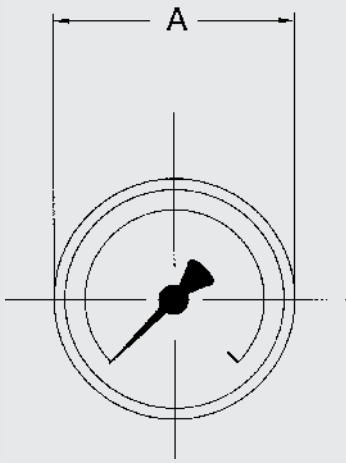

Size		(Standard Version)						
		A	C	D	G	T	W	Weight <sup>1</sup>
1.5"	mm	40	26	41	46.5		14	
	in	1.57	1.02	1.61	1.83	1/8"	0.55	0.16 lb.
2"	mm	50	26.5	49	47		14	
	in	1.97	1.04	1.93	1.85	1/4"	0.55	0.22 lb.
2.5"	mm	63	27.5	61.5	48		14	
	in	2.48	1.08	2.42	1.89	1/4"	0.55	0.29 lb.

<sup>1</sup> Weight is for base gauge without optional accessories.



### Ordering information

Pressure gauge model / Nominal size / Scale range / Size of connection / Optional extras required.  
Specifications and dimensions given in this leaflet represent the state of engineering at the time of printing.  
Modifications may take place and materials specified may be replaced by others without prior notice.

Copyright 2015 WIKA Instrument, LP. All rights reserved.

**WIKAL Instrument, LP**  
1000 Wiegand Boulevard  
Lawrenceville, GA 30043  
Tel (770) 513-8200 Toll-free 1-888-WIKA-USA  
Fax (770) 338-5118  
E-Mail [info@wika.com](mailto:info@wika.com)  
[www.wika.com](http://www.wika.com)