



**canfield  
connector**

**CANGRIP SERIES**  
STRAIN RELIEF  
CORD GRIPS

## GENERAL DESCRIPTION

The Canfield Connector CanGrip (brand) is a series of wire bulkhead feed through connectors which have integrated wire strain relief and sealing mechanism. The CanGrip are made from rugged engineered materials which are impervious to dust and moisture. Available in Nickel Plated Brass Strain Relief, Stainless Steel Strain Relief, Nylon Strain Relief, and Nylon Flex Strain Relief versions with various NPT, PG, and metric thread sizes featuring NBR seal material. Canfield Connector CanGrips are compatible with wire diameters from .079" to 1.732" (.709" for Flex), to ensure a tight fit while enhancing any wire installation.



## DIMENSIONAL DATA

All dimensions are in millimeters unless otherwise noted.

### NICKEL PLATED BRASS STRAIN RELIEF

## ORDERING INFORMATION

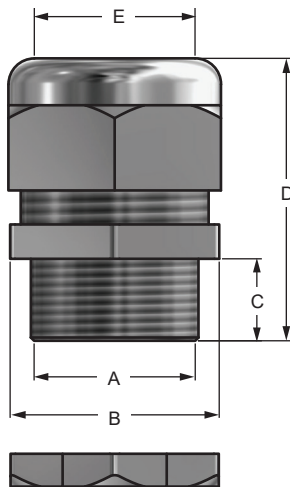

Dimensions					Part Number
A	B (In)	C (In)	D (In)	E Range (In)	Nickel Plated Brass
PG-7	0.630	0.315	1.181	0.118-0.256"	CANTOP-S010
				0.079-0.197"	CANTOP-S020
PG-9	0.748	0.315	1.339	0.157-0.315"	CANTOP-S030
				0.079-0.236"	CANTOP-S040
PG-11	0.866	0.315	1.378	0.197-0.394"	CANTOP-S050
				0.118-0.276"	CANTOP-S060
PG-13.5	0.945	0.354	1.457	0.236-0.472"	CANTOP-S070
				0.197-0.354"	CANTOP-S080
PG-16	1.063	0.394	1.575	0.394-0.551"	CANTOP-S090
				0.276-0.472"	CANTOP-S100
PG21	1.299	0.394	1.772	0.512-0.709"	CANTOP-S110
				0.354-0.630"	CANTOP-S120
PG-29	1.654	0.472	2.047	0.709-0.984"	CANTOP-S130
				0.512-0.787"	CANTOP-S140
PG-36	2.087	0.551	2.441	0.866-1.260"	CANTOP-S150
				0.787-1.024"	CANTOP-S160
PG-42	2.402	0.551	2.480	1.260-1.496"	CANTOP-S170
				0.984-1.220"	CANTOP-S180
PG-48	2.559	0.551	2.520	1.457-1.732"	CANTOP-S190
				1.142-1.378"	CANTOP-S200
NPT 3/8"	0.748	0.591	1.614	0.157-0.315"	CANTOP-S210
				0.079-0.236"	CANTOP-S220
NPT 1/2"	0.945	0.591	1.693	0.236-0.472"	CANTOP-S230
				0.197-0.354"	CANTOP-S240
NPT 3/4"	1.299	0.591	2.047	0.512-0.709"	CANTOP-S250
				0.354-0.630"	CANTOP-S260
NPT 1"	1.614	0.630	2.205	0.709-0.984"	CANTOP-S270
				0.512-0.787"	CANTOP-S280

## DIMENSIONAL DATA CONT.

All dimensions are in millimeters unless otherwise noted.

## STAINLESS STEEL STRAIN RELIEF

## ORDERING INFORMATION

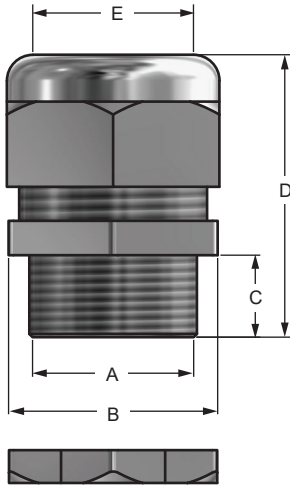

Dimensions					Part Number
A	B (In)	C (In)	D (In)	E Range (In)	Stainless Steel
PG-7	0.630	0.315	1.181	0.118-0.256"	CANTOP-S013*
				0.079-0.197"	CANTOP-S023*
PG-9	0.748	0.315	1.339	0.157-0.315"	CANTOP-S033*
				0.079-0.236"	CANTOP-S043*
PG-11	0.866	0.315	1.378	0.197-0.394"	CANTOP-S053
				0.118-0.276"	CANTOP-S063*
PG-13.5	0.945	0.354	1.457	0.236-0.472"	CANTOP-S073*
				0.197-0.354"	CANTOP-S083*
PG-16	1.063	0.394	1.575	0.394-0.551"	CANTOP-S093*
				0.276-0.472"	CANTOP-S103*
PG21	1.299	0.394	1.772	0.512-0.709"	CANTOP-S113*
				0.354-0.630"	CANTOP-S123*
PG-29	1.654	0.472	2.047	0.709-0.984"	CANTOP-S133*
				0.512-0.787"	CANTOP-S143*
PG-36	2.087	0.551	2.441	0.866-1.260"	CANTOP-S153*
				0.787-1.024"	CANTOP-S163*
PG-42	2.402	0.551	2.480	1.260-1.496"	CANTOP-S173*
				0.984-1.220"	CANTOP-S183*
PG-48	2.559	0.551	2.520	1.457-1.732"	CANTOP-S193*
				1.142-1.378"	CANTOP-S203*
NPT 3/8"	0.748	0.591	1.614	0.157-0.315"	CANTOP-S213*
				0.079-0.236"	CANTOP-S223*
NPT 1/2"	0.945	0.591	1.693	0.236-0.472"	CANTOP-S233*
				0.197-0.354"	CANTOP-S243*
NPT 3/4"	1.299	0.591	2.047	0.512-0.709"	CANTOP-S253*
				0.354-0.630"	CANTOP-S263*
NPT 1"	1.614	0.630	2.205	0.709-0.984"	CANTOP-S273*
				0.512-0.787"	CANTOP-S283*

\*Not a stocked item. Consult Factory for availability

# DIMENSIONAL DATA CONT.

All dimensions are in millimeters unless otherwise noted.

## NYLON STRAIN RELIEF

### ORDERING INFORMATION

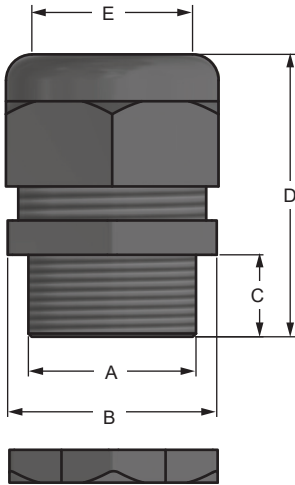

Dimensions					Part Number	
A	B (In)	C (In)	D (In)	E Range (In)	Gray	Black
PG-7	0.630	0.315	1.181	0.118-0.256"	CANTOP-S011	CANTOP-S012
				0.079-0.197"	CANTOP-S021	CANTOP-S022
PG-9	0.748	0.315	1.339	0.157-0.315"	CANTOP-S031	CANTOP-S032
				0.079-0.236"	CANTOP-S041	CANTOP-S042
PG-11	0.866	0.315	1.378	0.197-0.394"	CANTOP-S051	CANTOP-S052
				0.118-0.276"	CANTOP-S061	CANTOP-S062
PG-13.5	0.945	0.354	1.457	0.236-0.472"	CANTOP-S071	CANTOP-S072
				0.197-0.354"	CANTOP-S081	CANTOP-S082
PG-16	1.063	0.394	1.575	0.394-0.551"	CANTOP-S091	CANTOP-S092
				0.276-0.472"	CANTOP-S101	CANTOP-S102
PG21	1.299	0.394	1.772	0.512-0.709"	CANTOP-S111	CANTOP-S112
				0.354-0.630"	CANTOP-S121	CANTOP-S122
PG-29	1.654	0.472	2.047	0.709-0.984"	CANTOP-S131	CANTOP-S132
				0.512-0.787"	CANTOP-S141	CANTOP-S142
PG-36	2.087	0.551	2.441	0.866-1.260"	CANTOP-S151	CANTOP-S152
				0.787-1.024"	CANTOP-S161	CANTOP-S162
PG-42	2.402	0.551	2.480	1.260-1.496"	CANTOP-S171	CANTOP-S172
				0.984-1.220"	CANTOP-S181	CANTOP-S182
PG-48	2.559	0.551	2.520	1.457-1.732"	CANTOP-S191	CANTOP-S192
				1.142-1.378"	CANTOP-S201	CANTOP-S202
NPT 3/8"	0.748	0.591	1.614	0.157-0.315"	CANTOP-S211	CANTOP-S212
				0.079-0.236"	CANTOP-S221	CANTOP-S222
NPT 1/2"	0.945	0.591	1.693	0.236-0.472"	CANTOP-S231	CANTOP-S232
				0.197-0.354"	CANTOP-S241	CANTOP-S242
NPT 3/4"	1.299	0.591	2.047	0.512-0.709"	CANTOP-S251	CANTOP-S252
				0.354-0.630"	CANTOP-S261	CANTOP-S262
NPT 1"	1.614	0.630	2.205	0.709-0.984"	CANTOP-S271	CANTOP-S272
				0.512-0.787"	CANTOP-S281	CANTOP-S282
M12X1.5	0.630	0.315	1.181	0.118-0.256"	CANTOP-S291*	CANTOP-S292*
				0.079-0.197"	CANTOP-S301*	CANTOP-S302*
M16X1.5	0.748	0.315	1.339	0.157-0.315"	CANTOP-S311*	CANTOP-S312*
				0.079-0.236"	CANTOP-S321*	CANTOP-S322*
M18X1.5	0.866	0.315	1.378	0.197-0.394"	CANTOP-S331*	CANTOP-S332*
				0.118-0.276"	CANTOP-S341*	CANTOP-S342*
M20X1.5	0.945	0.354	1.456	0.236-0.472"	CANTOP-S351*	CANTOP-S352*
				0.197-0.354"	CANTOP-S361*	CANTOP-S362*
M22X1.5	1.063	0.394	1.575	0.394-0.551"	CANTOP-S371*	CANTOP-S372*
				0.276-0.472"	CANTOP-S381*	CANTOP-S382*
M25X1.5	1.300	0.394	1.772	0.512-0.709"	CANTOP-S391*	CANTOP-S392*
				0.354-0.630"	CANTOP-S401*	CANTOP-S402*
M32X1.5	1.437	0.433	2.008	0.709-0.984"	CANTOP-S411*	CANTOP-S412*
				0.512-0.787"	CANTOP-S421*	CANTOP-S422*
M40X1.5	2.067	1.575	3.465	0.866-1.260"	CANTOP-S431*	CANTOP-S432*
				0.787-1.024"	CANTOP-S441*	CANTOP-S442*
M50X1.5	2.382	1.575	3.504	1.260-1.496"	CANTOP-S451*	CANTOP-S452*
				0.984-1.220"	CANTOP-S461*	CANTOP-S462*
M63X1.5	2.638	1.575	3.544	1.457-1.732"	CANTOP-S471*	CANTOP-S472*
				1.142-1.378"	CANTOP-S481*	CANTOP-S482*

\*Not a stocked item. Consult Factory for availability

## DIMENSIONAL DATA CONT.

All dimensions are in millimeters unless otherwise noted.

## NYLON FLEX STRAIN RELIEF

### ORDERING INFORMATION

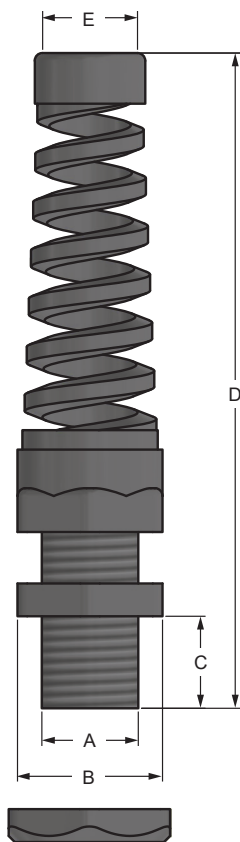

Dimensions					Part Number	
A	B (In)	C (In)	D (In)	E Range (In)	Gray	Black
PG-7	0.669	0.315	2.874	0.118-0.256"	CANTOP-F011	CANTOP-F012
				0.079-0.197"	CANTOP-F021	CANTOP-F022
PG-9	0.787	0.315	3.071	0.157-0.315"	CANTOP-F031	CANTOP-F032
				0.079-0.236"	CANTOP-F041	CANTOP-F042
PG-11	0.866	0.315	3.386	0.197-0.394"	CANTOP-F051	CANTOP-F052
				0.118-0.276"	CANTOP-F061	CANTOP-F062
PG-13.5	0.945	0.354	3.898	0.236-0.472"	CANTOP-F071	CANTOP-F072
				0.197-0.354"	CANTOP-F081	CANTOP-F082
PG-16	1.063	0.394	4.331	0.394-0.551"	CANTOP-F091	CANTOP-F092
				0.276-0.472"	CANTOP-F101	CANTOP-F102
PG21	1.339	0.394	4.803	0.512-0.709"	CANTOP-F111	CANTOP-F112
				0.354-0.630"	CANTOP-F121	CANTOP-F122
NPT 3/8"	0.787	0.591	3.346	0.157-0.315"	CANTOP-F271	CANTOP-F272
				0.079-0.236"	CANTOP-F281	CANTOP-F282
NPT 1/2"	0.945	0.591	4.134	0.236-0.472"	CANTOP-F291	CANTOP-F292
				0.197-0.354"	CANTOP-F301	CANTOP-F302
NPT 3/4"	1.339	0.591	5.079	0.512-0.709"	CANTOP-F311	CANTOP-F312
				0.354-0.630"	CANTOP-F321	CANTOP-F322
M12X1.5	0.669	0.315	2.874	0.118-0.256"	CANTOP-F131	CANTOP-F132
				0.079-0.197"	CANTOP-F141*	CANTOP-F142
M16X1.5	0.787	0.315	3.071	0.157-0.315"	CANTOP-F151	CANTOP-F152
				0.079-0.236"	CANTOP-F161*	CANTOP-F162*
M18X1.5	0.866	0.315	3.386	0.197-0.394"	CANTOP-F171	CANTOP-F172
				0.118-0.276"	CANTOP-F181*	CANTOP-F182*
M20X1.5	0.945	0.354	3.898	0.236-0.472"	CANTOP-F191	CANTOP-F192
				0.197-0.354"	CANTOP-F201*	CANTOP-F202*
M22X1.5	1.063	0.394	4.331	0.394-0.551"	CANTOP-F211	CANTOP-F212
				0.276-0.472"	CANTOP-F221	CANTOP-F222*
M25X1.5	1.339	0.394	4.803	0.512-0.709"	CANTOP-F231	CANTOP-F232
				0.354-0.630"	CANTOP-F241*	CANTOP-F242*

\*Not a stocked item. Consult Factory for availability

### TECHNICAL DATA

<b>Materials</b>	Plastic Housing: Nylon Metal Housing: Nickel Plated Brass, or Stainless Steel Grommet: NBR
<b>Temp Range</b>	-40° to +100°C
<b>Environmental Protection</b>	Designed for IP 68 / NEMA 6
<b>Size</b>	Strain Relief: .079" - 1.732" Flex: 0.79" - .709"



**Ordering Example:** CANTOP-F011

Nylon flex CanGrip, PG-7, 0.118-0.256", gray