

## Metalex Socket Weld Mini-Tap (1.4401)

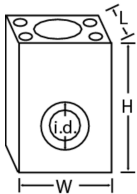

- For use with SS pipe

Type	DN (mm)	Size (inch)	for sensor	Part No.	weight (kg)	L (inch)	W (inch)	H (inch)	i.d. (inch)
P526-2005	15	0.50	P525-1, 1S	<b>198 840 501</b>	0.320	2	2.4	3	0.85
P526-2007	20	0.75	P525-1, 1S	<b>198 840 502</b>	1.800	2	2.4	3	1.06
P526-2010	25	1.00	P525-1, 1S	<b>198 840 503</b>	1.600	2	2.4	3	1.33



The technical data are not binding. They neither constitute expressly warranted characteristics nor guaranteed properties nor a guaranteed durability. They are subject to modification. Our General Terms of Sale apply.

Georg Fischer Piping Systems Ltd, Postfach, CH-8201 Schaffhausen/Switzerland

Phone +41 -(0)52-631 1111

e-mail: [info.ps@georgfischer.com](mailto:info.ps@georgfischer.com)

Internet: <http://www.gfps.com>